

LED street light Tiger MZ11 Series

Mz11 SERIES

LED STREET LIGHT



APPLICATIONS

Road, street, square, sidewalk, bicycle lane, parking lot, park and other places lighting.

Specification Features

- Simple modeling, die casting and glass. Finish color is optional.
- A variety of PC module lenses can meet the needs of various road light distribution;
- CCT: 3000K/4000K/5000K;
- IP66 design, suitable for wet location, 5mm glass for IK08;
- Optional LED : 3030,3535,5050;
- Optional LED135LM/W, 150LM/W
- Designed for Ø42-Ø60mm pole, easy and fast installation.
- Optional: 10kv spd, 3 pin,5 pin,7 pin.;
- Operating temperature: -40°C ~ 45°C;
- Installation bracket(Angel): 0-20 degree



IP66

Photometrics

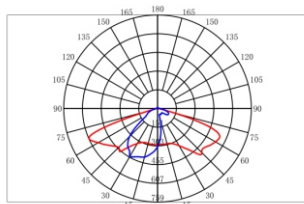

TP-III-M

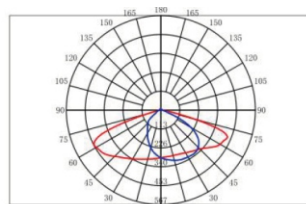

TP-III-S

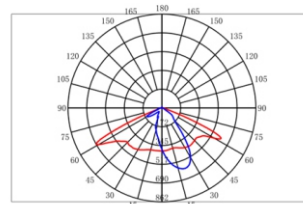

TP-II-M

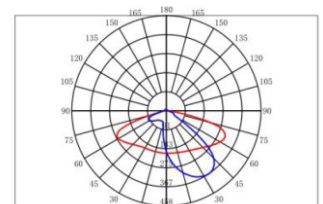

TP-II-S

Product size

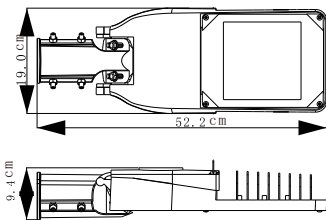

35~60W

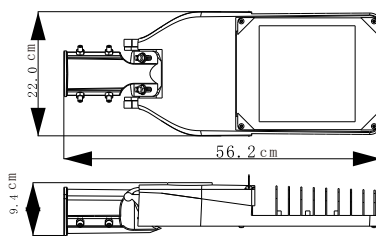

80~120W

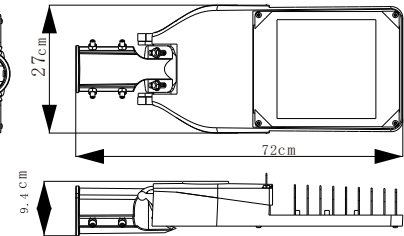

150~200W

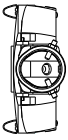

LED Street Light Parameter table

Item description	35W MZ11 LD001	60W MZ11 LD001	80W MZ11 LD001	100W MZ11 LD001	120W MZ11 LD001	150W MZ11 LD001	180W MZ11 LD001	200W MZ11 LD001
Input voltage/frequency [VAC][Hz]	100-277VAC 50/60Hz							
Input current (MAX) [A]	0.385	0.66	0.88	1.1	1.32	1.65	1.65	2.2
Input watt [W]	35 ± 5%	60 ± 5%	80 ± 5%	100 ± 5%	120 ± 5%	150 ± 5%	180 ± 5%	200 ± 5%
Power factor	> 0.9@220V							
Voltage [V]	36							
Current(reference) [A]	0.86	1.5	2.0	2.56	3.06	3.83	4.61	5.11
Wattage(reference) [W]	31 ± 5%	54 ± 5%	72 ± 5%	81 ± 5%	110 ± 5%	138 ± 5%	138 ± 5%	184 ± 5%
Luminous flux @5000K [Lm]	4725	8100	10800	13500	16200	20250	24300	27000
Colour temperature [K]	2700-6500							
Colour rendering index [Ra]	70							
Beam angle [H, V]	TP-II-S, TYPEII-M, TP-III-S, TYPEIII-M							
Average life [h]	50000							
Ambient temperature	-40°C - 45°C							
Chip	CREE3030, Lumileds3030							
Material	ADC12+Glass							
Storage environment	-40°C-85°C RH10%-95%							
Packing dimensions	575*240*150mm			615*270*150mm			775*320*150mm	

Item description	35W MZ11 LD002	60W MZ11 LD002	80W MZ11 LD002	100W MZ11 LD002	120W MZ11 LD002	150W MZ11 LD002	180W MZ11 LD002	200W MZ11 LD002
Input voltage/frequency [VAC][Hz]	100-277VAC 50/60Hz							
Input current (MAX) [A]	0.385	0.66	0.88	1.1	1.32	1.65	1.65	2.2
Input watt [W]	35 ± 5%	60 ± 5%	80 ± 5%	100 ± 5%	120 ± 5%	150 ± 5%	180 ± 5%	200 ± 5%
Power factor	> 0.9@220V							
Voltage [V]	48							
Current(reference) [A]	0.66	1.14	1.52	1.93	2.3	2.89	3.47	3.85
Wattage(reference) [W]	31 ± 5%	54 ± 5%	72 ± 5%	92 ± 5%	110 ± 5%	138 ± 5%	166 ± 5%	184 ± 5%
Luminous flux @5000K [Lm]	5250	9000	12000	15000	18000	22500	27000	30000
Colour temperature [K]	2700-6500							
Colour rendering index [Ra]	70							
Beam angle [H, V]	TYPEII-M/TYPE-III-S							
Average life [h]	50000							
Ambient temperature	-40°C - 45°C							
Chip	TYF5050							
Material	ADC12+Glass							
Storage environment	-40°C-85°C RH10%-95%							
Packing dimensions	575*240*150mm			615*270*150mm			775*320*150mm	

Installation Diagram

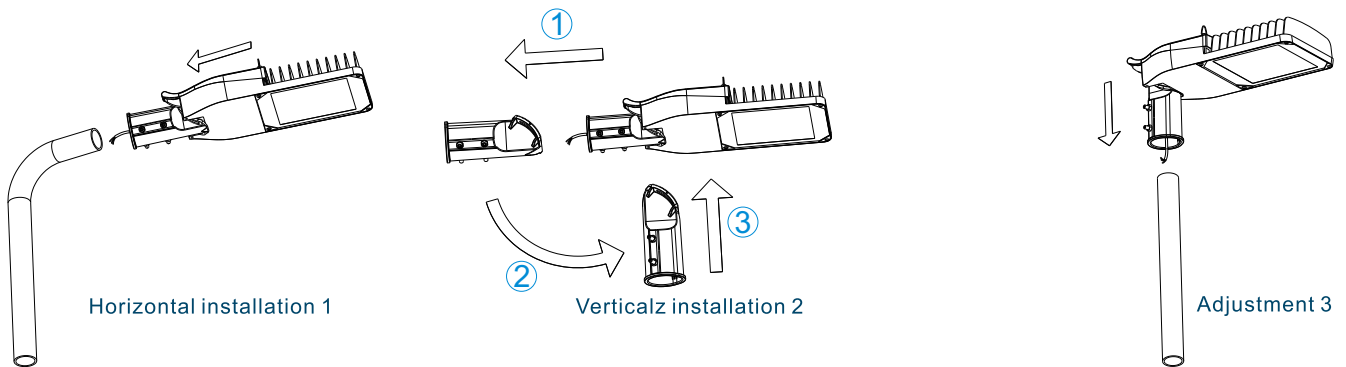

1. Please adjust the angle of the fixture before installation according to the lamp post in real usage: 1) Horizontal (Shown as diagram); 2) Vertical: take the tail bracket off from the housing and assemble it vertically and fasten again(Shown as diagram 2). The adjust range for both of installations is 10 plus or minus, and the range of lamp post diameter is from 40mm to 60mm. Could open new mould to make new mounting bracket suitable for $\Phi 60-76$ mm pole.
2. Connect the light to the power source by the wire sign and make sure it be earthed well.
3. Insert the lamp post into the light and protect the cables during installation.
4. Fixt the light with four bolts and lock it up with nuts

Notes:

1. Recheck the luminaire after installation and make sure it be fixed well without loosing.
2. Insulate the bare wires and prevent it from short circuit.
3. Make sure the luminaire be earthed well and prevent it from electric leakage.
4. Fastening screws could be special made in order to prevent the luminaire from being removed from the support arm.